



# ANLY CONTROLLER

## AVM MONITORING & PROTECTION RELAY



### CHARACTERISTIC :

- Protect against :
  - Over Voltage (5% ~ 20%)
  - Under Voltage (5% ~ 20%)
  - Phase Reversal
  - Phase Loss
  - Phase Unbalance ( $\pm 20\%$ )
- Phase Loss is monitored at start-up and while operating
- Fixed 3 second delay for Phase Unbalance

### SPECIFICATION :

Operating voltage	AC(V): 220, 240, 380, 415, 440
Allowable operating voltage range	$\pm 5\% \sim \pm 20\%$ of rated operating voltage
Rated frequency	50 / 60 Hz
Detecting method	Detect 3-phase supply voltage
Reset time	MAX 2S
Contact rating	250VAC 5A (resistive load)
Power consumption	Approx. 2VA
Life	Mechanical: 5,000,000 times Electrical: 100,000 times
Ambient temperature	$-10 \sim +50^{\circ}\text{C}$ (without condensation & freezing)
Ambient humidity	MAX 85% RH (without condensation)
Altitude	MAX 2000m
Weight	Approx. 210g

### TYPE SELECTION :

Type	3-Phase 3-Wire		1-Phase 2-Wire	
Standard	AVM-NK	AVM-YK	AVM-NS	AVM-YS
APR-3 Compatible	AVM-NR	AVM-YR	----	----

## CONNECTION :

## INDICATOR :

AVM-□K

AVM-□R

AVM-□S

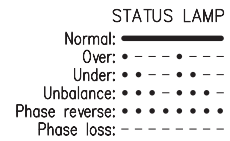
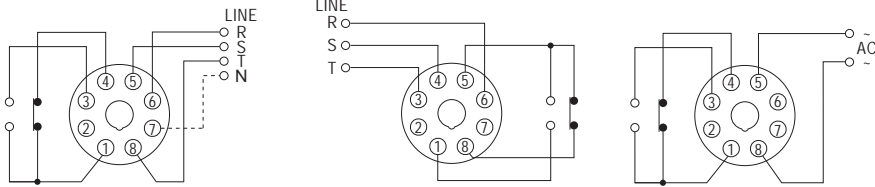

## TIMING CHART :

AVM-□K

AVM-□R

AVM-□S

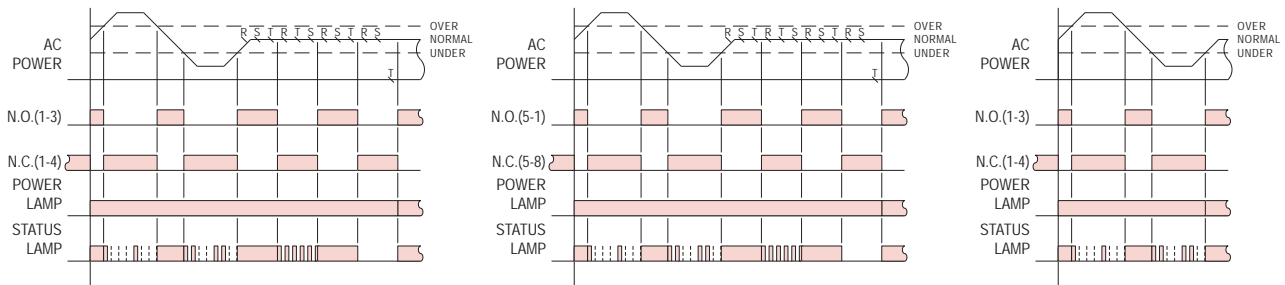

## DIMENSIONS : (mm)

N type(Surface Mounting): Using 8PFA Socket

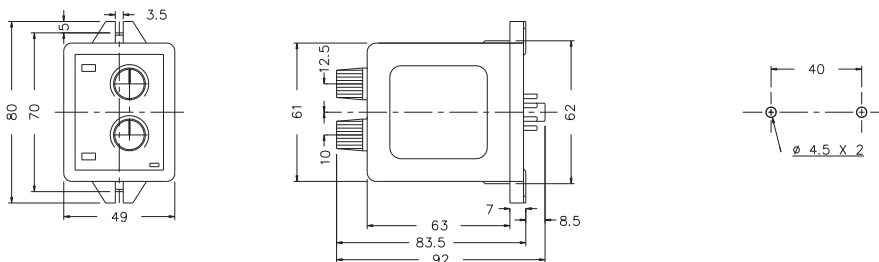

Y type(Flush Mounting): Using US-08 Socket or P3G-08 Socket

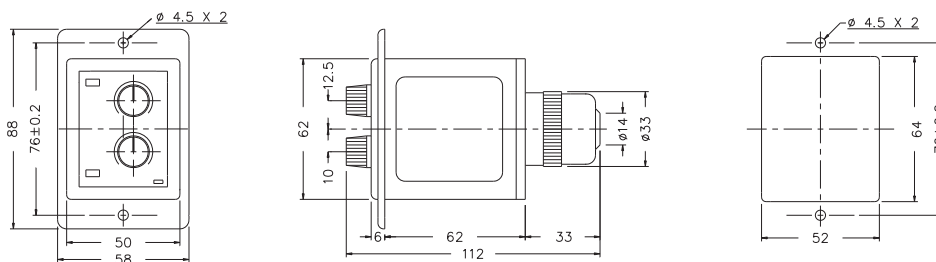

**ANLY ELECTRONICS CO., LTD.**

<http://www.anly.com.tw>

**TAIWAN MAIN OFFICE : ANLY ELECTRONICS CO., LTD.**

No.19, Lane 202, Fushou St., Xinzhuang Dist., New Taipei City 242, Taiwan  
TEL: +886-2-2996-3202 FAX: +886-2-2996-2017

**MALAYSIA BRANCH : JUSTY ELECTRONICS (M) SDN, BHD.**

No.1, Jalan 6/89B, Kawasan Perindustrian Trisegi, Batu 3 1/2 Off Jalan Sungei Besi, 57100 Kuala Lumpur, Malaysia  
TEL: +60-3-7983-5758 FAX: +60-3-7981-5052

**HONG KONG BRANCH : ANLY ELECTRONICS (HK) LTD.**

Flat K, 13/F, Edward Mansion, 141 Prince Edward Road W., Kowloon, Hong Kong  
TEL: +852-2397-2505 FAX: +852-2397-6080

**SHANGHAI BRANCH : ANLY TECHNOLOGY (WUXI) CO., LTD.**

Room 13G, No.831, Xinzha Rd., Jingan District, Shanghai, China 200041  
TEL: +86-21-6218-3300 FAX: +86-21-6217-5911

NO. AVM-Q-A